

Self-Lube[®] bearing inserts

1000G and 1100 Series

1000G

With spherical outside diameter and integral set screw lock

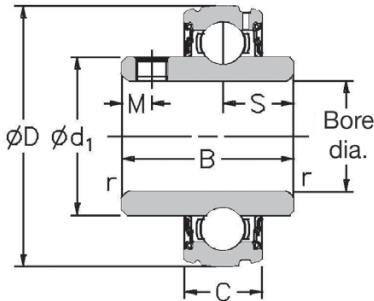

1100

With parallel outside diameter and integral set screw lock

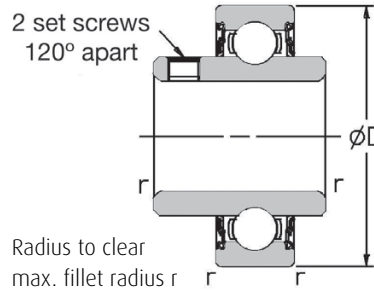

Radius to clear max. fillet radius r

Shaft diameter		RHP designation		Dimensions (mm)						ISO Load ratings		Rec. max. speed	Mass (approx.)	
mm	inches	1000G Series	1100 Series	D	C	B	s	d1	M	r	dynamic Cr newtons	static Cor newtons	rev/min	kg
12		1017-12G	1117-12	40.000	12.00	27.38	11.58	24.80	5.00	0.60	9550	4800	7000	0.09
15		1017-15G	1117-15											
16		1017-16G	1117-16											
17		1017-17G	1117-17											
	1/2	1017-1/2G	1117-1/2											
	5/8	1017-5/8G	1117-5/8											
20		1020-20G	1120-20	47.000	14.00	31.00	12.73	28.30	5.00	1.00	12800	6650	6700	0.13
	3/4	1020-3/4G	1120-3/4											
25		1025-25G	1125-25	52.000	15.00	34.10	14.33	34.00	5.00	1.00	14000	7880	6250	0.17
	7/8	1025-7/8G	1125-7/8											
	15/16	1025-15/16G	1125-15/16											
	1	1025-1G	1125-1											
25		1030-25G	1130-25	62.000	16.00	38.10	15.93	40.30	5.00	1.00	19500	11300	5300	0.37
30		1030-30G	1130-30											
	1	1030-1G	1130-1											
	1 1/8	1030-1 1/8G	1130-1 1/8											
	1 3/16	1030-1 3/16G	1130-1 3/16											
	1 1/4	1030-1 1/4G	1130-1 1/4											
30		1035-30G	1135-30	72.000	17.00	42.90	17.53	46.90	6.50	1.00	25700	15300	4500	0.51
35		1035-35G	1135-35											
	1 3/16	1035-1 3/16G	1135-1 3/16											
	1 1/4	1035-1 1/4G	1135-1 1/4											
	1 5/16	1035-1 5/16G	1135-1 5/16											
	1 3/8	1035-1 3/8G	1135-1 3/8											
	1 7/16	1035-1 7/16G	1135-1 7/16											
35		1040-35G	1140-35	80.000	18.00	49.20	19.03	52.40	8.00	1.00	32500	19900	4000	0.64
40		1040-40G	1140-40											
	1 3/8	1040-1 3/8G	1140-1 3/8											
	1 7/16	1040-1 7/16G	1140-1 7/16											
	1 1/2	1040-1 1/2G	1140-1 1/2											
40		1045-40G	1145-40	85.000	19.00	49.20	19.04	57.40	8.00	1.00	32500	20500	3700	0.73
45		1045-45G	1145-45											
	1 1/2	1045-1 1/2G	1145-1 1/2											
	1 5/8	1045-1 5/8G	1145-1 5/8											
	1 11/16	1045-1 11/16G	1145-1 11/16											
	1 3/4	1045-1 3/4G	1145-1 3/4											
45		1050-45G	1150-45	90.000	20.00	51.60	19.04	62.40	10.00	1.00	35000	23200	3400	0.91
50		1050-50G	1150-50											
	1 11/16	1050-1 11/16G	1150-1 11/16											
	1 3/4	1050-1 3/4G	1150-1 3/4											
	1 7/8	1050-1 7/8G	1150-1 7/8											
	1 15/16	1050-1 15/16G	1150-1 15/16											
	2	1050-2G	1150-2											
50		1055-50G	1155-50	100.000	21.00	55.60	22.24	68.90	10.00	1.50	43500	29200	3100	1.12
55		1055-55G	1155-55											
	1 7/8	1055-1 7/8G	1155-1 7/8											
	1 15/16	1055-1 15/16G	1155-1 15/16											
	2	1055-2G	1155-2											
	2 1/8	1055-2 1/8G	1155-2 1/8											
	2 3/16	1055-2 3/16G	1155-2 3/16											

Please check availability

Shaft diameter		RHP designation		Dimensions (mm)						ISO Load ratings		Rec. max. speed	Mass (approx.)	
mm	inches	1000G Series	1100 Series	D	C	B	s	d1	M	r	dynamic Cr newtons	static Cor newtons	rev/min	kg
55		1060-55G	1160-55	110.000	22.00	65.10	25.44	76.00	10.00	1.50	48000	33000	2800	1.47
60		1060-60G	1160-60											
	2 ³ / ₁₆	1060-2 ³ / ₁₆ G	1160-2 ³ / ₁₆											
	2 ¹ / ₄	1060-2 ¹ / ₄ G	1160-2 ¹ / ₄											
	2 ³ / ₈	1060-2 ³ / ₈ G	1160-2 ³ / ₈											
	2 ⁷ / ₁₆	1060-2 ⁷ / ₁₆ G	1160-2 ⁷ / ₁₆											
60		1065-60G	1165-60	120.000	23.00	65.10	25.44	82.50	10.00	1.50	57500	40000	2600	2.02
65		1065-65G	1165-65											
	2 ¹ / ₂	1065-2 ¹ / ₂ G	1165-2 ¹ / ₂											
60		1070-60G	1170-60	125.000	24.00	74.60	30.24	89.00	12.00	1.50	61000	45000	2450	2.27
65		1070-65G	1170-65											
70		1070-70G	1170-70											
	2 ⁷ / ₁₆	1070-2 ⁷ / ₁₆ G	1170-2 ⁷ / ₁₆											
	2 ¹ / ₂	1070-2 ¹ / ₂ G	1170-2 ¹ / ₂											
	2 ³ / ₈	1070-2 ³ / ₈ G	1170-2 ³ / ₈											
	2 ¹¹ / ₁₆	1070-2 ¹¹ / ₁₆ G	1170-2 ¹¹ / ₁₆											
65		1075-65G	1175-65	130.000	25.00	77.80	33.34	94.00	12.00	1.50	66000	49500	2300	2.61
70		1075-70G	1175-70											
75		1075-75G	1175-75											
	2 ¹¹ / ₁₆	1075-2 ¹¹ / ₁₆ G	1175-2 ¹¹ / ₁₆											
	2 ³ / ₄	1075-2 ³ / ₄ G	1175-2 ³ / ₄											
	2 ⁷ / ₈	1075-2 ⁷ / ₈ G	1175-2 ⁷ / ₈											
	2 ¹⁵ / ₁₆	1075-2 ¹⁵ / ₁₆ G	1175-2 ¹⁵ / ₁₆											
	3	1075-3G	1175-3											
75		1080-75G	1180-75	140.000	26.00	82.60	33.34	100.00	12.00	2.00	71500	54500	2150	3.23
80		1080-80G	1180-80											
	2 ¹⁵ / ₁₆	1080-2 ¹⁵ / ₁₆ G	1180-2 ¹⁵ / ₁₆											
	3	1080-3G	1180-3											
	3 ³ / ₁₆	1080-3 ³ / ₁₆ G	1180-3 ³ / ₁₆											
	3 ¹ / ₄	1080-3 ¹ / ₄ G	1180-3 ¹ / ₄											
80		1085-80G	1185-80	150.000	28.00	85.70	34.15	107.10	12.00	2.00	83000	64000	2000	3.74
85		1085-85G	1185-85											
	3 ³ / ₁₆	1085-3 ³ / ₁₆ G	1185-3 ³ / ₁₆											
	3 ¹ / ₄	1085-3 ¹ / ₄ G	1185-3 ¹ / ₄											
	3 ³ / ₈	1085-3 ³ / ₈ G	1185-3 ³ / ₈											
	3 ⁷ / ₁₆	1085-3 ⁷ / ₁₆ G	1185-3 ⁷ / ₁₆											
85		1090-85G	1190-85	160.000	30.00	96.00	39.74	111.50	15.00	2.00	96000	71500	1900	4.99
90		1090-90G	1190-90											
	3 ⁷ / ₁₆	1090-3 ⁷ / ₁₆ G	1190-3 ⁷ / ₁₆											
	3 ¹ / ₂	1090-3 ¹ / ₂ G	1190-3 ¹ / ₂											
95		3095-95G		200.000	45.00	117.48	49.31	127.10	16.00	2.50	157000	122000	1600	9.53
100		3095-100G												
	3 ¹⁵ / ₁₆	3095-3 ¹⁵ / ₁₆ G												
	4	3095-4G												

Self-Lube[®] bearing inserts

1000DECG and 1100DEC Series

1000DECG

With spherical outside diameter and eccentric collar lock

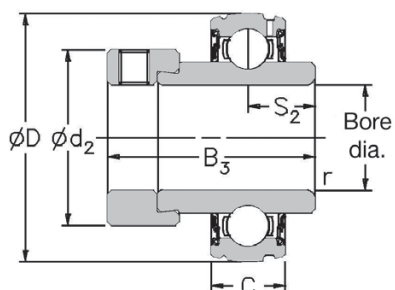

1100DEC

With parallel outside diameter and eccentric collar lock

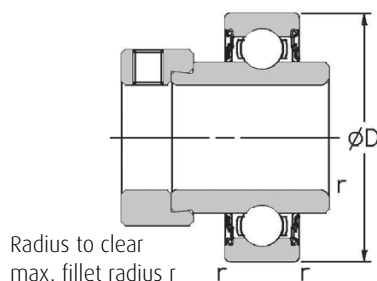

Shaft diameter		RHP designation		Dimensions (mm)						ISO Load ratings		Rec. max. speed	Mass (approx.)
mm	inches	1000DECG Series	1100DEC Series	D	C	B3	s2	d2	r	dynamic Cr newtons	static Cor newtons	rev/min	kg
20		1020-20DECG	1120-20DEC	47.000	14.00	43.73	17.13	33.30	1.00	12800	6650	6700	0.20
	3/4	1020-3/4DECG	1120-3/4DEC										
25		1025-25DECG	1125-25DEC	52.000	15.00	44.43	17.53	38.10	1.00	14000	7880	6250	0.26
	7/8	1025-7/8DECG	1125-7/8DEC										
	15/16	1025-15/16DECG	1125-15/16DEC										
	1	1025-1DECG	1125-1DEC										
30		1030-30DECG	1130-30DEC	62.000	16.00	48.43	18.33	44.50	1.00	19500	11300	5300	0.53
	1 1/8	1030-1 1/8DECG	1130-1 1/8DEC										
	1 3/16	1030-1 3/16DECG	1130-1 3/16DEC										
	1 1/4	1030-1 1/4DECG	1130-1 1/4DEC										
35		1035-35DECG	1135-35DEC	72.000	17.00	51.13	18.83	55.60	1.00	25700	15300	4500	0.70
	1 1/4	1035-1 1/4DECG	1135-1 1/4DEC										
	1 3/8	1035-1 3/8DECG	1135-1 3/8DEC										
	1 7/16	1035-1 7/16DECG	1135-1 7/16DEC										
40		1040-40DECG	1140-40DEC	80.000	18.00	56.33	21.43	60.30	1.00	32500	19900	4000	0.82
	1 1/2	1040-1 1/2DECG	1140-1 1/2DEC										
45		1045-45DECG	1145-45DEC	85.000	19.00	56.33	21.43	63.50	1.00	32500	20500	3700	1.08
	1 5/8	1045-1 5/8DECG	1145-1 5/8DEC										
	1 11/16	1045-1 11/16DECG	1145-1 11/16DEC										
	1 3/4	1045-1 3/4DECG	1145-1 3/4DEC										
50		1050-50DECG	1150-50DEC	90.000	20.00	62.73	24.64	69.90	1.00	35000	23200	3400	1.19
	1 7/8	1050-1 7/8DECG	1150-1 7/8DEC										
	1 5/8	1050-1 5/8DECG	1150-1 5/8DEC										
55		1055-55DECG	1155-55DEC	100.000	21.00	71.42	27.84	76.20	1.50	43500	29200	3100	1.40
	2	1055-2DECG	1155-2DEC										
	2 1/8	1055-2 1/8DECG	1155-2 1/8DEC										
	2 3/16	1055-2 3/16DECG	1155-2 3/16DEC										
60		1060-60DECG	1160-60DEC	110.000	22.00	77.84	31.04	84.20	1.50	48000	33000	2800	1.72
	2 1/4	1060-2 1/4DECG	1160-2 1/4DEC										
	2 3/8	1060-2 3/8DECG	1160-2 3/8DEC										
	2 7/16	1060-2 7/16DECG	1160-2 7/16DEC										
	2 1/2	1065-2 1/2DECG	1165-2 1/2DEC	120.000	23.00	85.74	34.14	92.00	1.50	57500	40000	2600	2.21
65		1070-65DECG	1170-65DEC	125.000	24.00	85.74	34.14	97.00	1.50	61000	45000	2450	2.56
70		1070-70DECG	1170-70DEC										
	2 1/2	1070-2 1/2DECG	1170-2 1/2DEC										
	2 5/8	1070-2 5/8DECG	1170-2 5/8DEC										
	2 11/16	1070-2 11/16DECG	1170-2 11/16DEC										
65		1075-65DECG	1175-65DEC	130.000	25.00	92.14	37.34	102.00	1.50	66000	49500	2300	2.94
70		1075-70DECG	1175-70DEC										
75		1075-75DECG	1175-75DEC										
	2 11/16	1075-2 11/16DECG	1175-2 11/16DEC										
	2 3/4	1075-2 3/4DECG	1175-2 3/4DEC										
	2 7/8	1075-2 7/8DECG	1175-2 7/8DEC										
	2 15/16	1075-2 15/16DECG	1175-2 15/16DEC										

Please check availability

Self-Lube[®] bearing inserts 1200G and 1300 Series

1200G

With spherical outside diameter and integral set screw lock

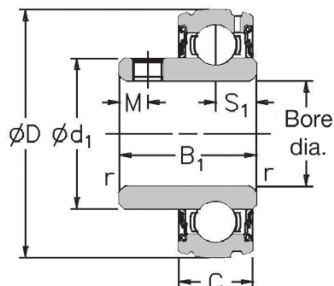

1300

With parallel outside diameter and integral set screw lock

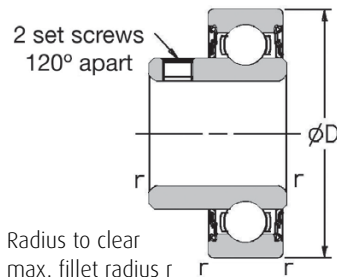

Shaft diameter		RHP designation		Dimensions (mm)							ISO Load ratings		Rec. max. speed rev/min	Mass (approx.) kg
				D	C	B1	s1	d1	M	r	dynamic Cr newtons	static Cor newtons		
20		1220-20G	1320-20	47.000	14.00	25.80	7.53	28.30	5.00	1.00	12800	6650	6700	0.10
	3/4	1220-3/4G	1320-3/4											
25		1225-25G	1325-25	52.000	15.00	27.30	7.53	34.00	5.00	1.00	14000	7880	6250	0.13
	1	1225-1G	1325-1											
30		1230-30G	1330-30	62.000	16.00	31.20	9.03	40.30	5.00	1.00	19500	11300	5300	0.32
	1 1/4	1230-1 1/4G	1330-1 1/4											
35		1235-35G	1335-35	72.000	17.00	34.90	9.53	46.90	6.50	1.00	25700	15300	4500	0.43
	1 1/4	1235-1 1/4G	1335-1 1/4											
40		1240-40G	1340-40	80.000	18.00	41.20	11.03	52.40	8.00	1.00	32500	19900	4000	0.54
	1 1/2	1240-1 1/2G	1340-1 1/2											
45		1245-45G	1345-45	85.000	19.00	41.20	11.04	57.40	8.00	1.00	32500	20500	3700	0.61
	1 3/4	1245-1 3/4G	1345-1 3/4											
50		1250-50G	1350-50	90.000	20.00	43.50	11.04	62.40	10.00	1.00	35000	23200	3400	0.76

Please check availability

Self-Lube[®] bearing inserts

1200EC and 1200ECG Series

1300EC Series

1200EC

With spherical outside diameter, non-re-greaseable outer ring and eccentric collar lock

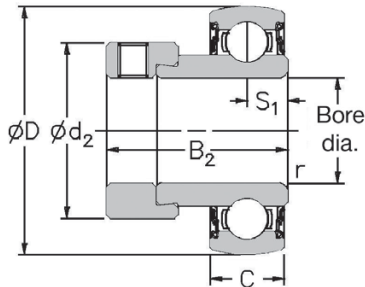

1200ECG

With spherical outside diameter, re-greaseable outer ring and eccentric collar lock

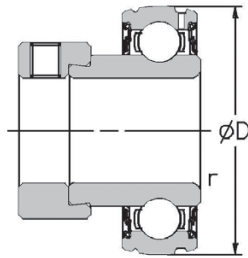

1300EC

With parallel outside diameter and eccentric collar lock

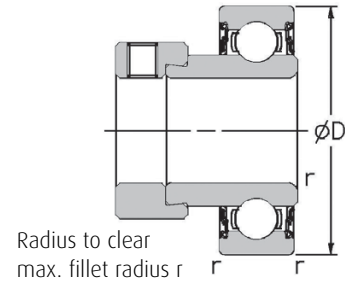

Shaft diameter mm inches	RHP designation			Dimensions (mm)						ISO Load ratings			Rec. max. speed rev/min	Mass (approx.) kg
	1200EC Series	1200ECG Series	1300EC Series	D	C	B2	s1	d2	r	dynamic Cr newtons	static Cor newtons			
12	1217-12EC	1217-12ECG	1317-12EC	40.000	12.00	28.63	6.53	28.60	0.60	9550	4800	7000	0.15	
15	1217-15EC	1217-15ECG	1317-15EC											
16	1217-16EC	1217-16ECG	1317-16EC											
17	1217-17EC	1217-17ECG	1317-17EC											
1/2	1217-1/2EC	1217-1/2ECG	1317-1/2EC											
5/8	1217-5/8EC	1217-5/8ECG	1317-5/8EC											
20	1220-20EC	1220-20ECG	1320-20EC	47.000	14.00	31.03	7.53	33.30	1.00	12800	6650	6700	0.16	
3/4	1220-3/4EC	1220-3/4ECG	1320-3/4EC											
25	1225-25EC	1225-25ECG	1325-25EC	52.000	15.00	31.03	7.53	38.10	1.00	14000	7880	6250	0.23	
7/8	1225-7/8EC	1225-7/8ECG	1325-7/8EC											
15/16	1225-15/16EC	1225-15/16ECG	1325-15/16EC											
1	1225-1EC	1225-1ECG	1325-1EC											
30	1230-30EC	1230-30ECG	1330-30EC	62.000	16.00	35.73	9.03	44.50	1.00	19500	11300	5300	0.40	
1 1/8	1230-1 1/8EC	1230-1 1/8ECG	1330-1 1/8EC											
1 3/16	1230-1 3/16EC	1230-1 3/16ECG	1330-1 3/16EC											
1 1/4	1230-1 1/4EC	1230-1 1/4ECG	1330-1 1/4EC											
35	1235-35EC	1235-35ECG	1335-35EC	72.000	17.00	38.93	9.53	55.60	1.00	25700	15300	4500	0.58	
1 1/4	1235-1 1/4EC	1235-1 1/4ECG	1335-1 1/4EC											
1 3/8	1235-1 3/8EC	1235-1 3/8ECG	1335-1 3/8EC											
1 7/16	1235-1 7/16EC	1235-1 7/16ECG	1335-1 7/16EC											
40	1240-40EC	1240-40ECG	1340-40EC	80.000	18.00	43.73	11.03	60.30	1.00	32500	19900	4000	0.73	
1 1/2	1240-1 1/2EC	1240-1 1/2ECG	1340-1 1/2EC											
45	1245-45EC	1245-45ECG	1345-45EC	85.000	19.00	43.73	11.03	63.50	1.00	32500	20500	3700	0.87	
1 5/8	1245-1 5/8EC	1245-1 5/8ECG	1345-1 5/8EC											
1 11/16	1245-1 11/16EC	1245-1 11/16ECG	1345-1 11/16EC											
1 3/4	1245-1 3/4EC	1245-1 3/4ECG	1345-1 3/4EC											
50	1250-50EC	1250-50ECG	1350-50EC	90.000	20.00	43.73	11.04	69.90	1.00	35000	23200	3400	0.98	
1 7/8	1250-1 7/8EC	1250-1 7/8ECG	1350-1 7/8EC											
1 5/8	1250-1 5/8EC	1250-1 5/8ECG	1350-1 5/8EC											
2	1250-2EC	1250-2ECG	1350-2EC											

Please check availability

Self-Lube[®] bearing inserts complete with snap ring

1100CG Series

1100CG

With parallel outside diameter and integral set screw lock

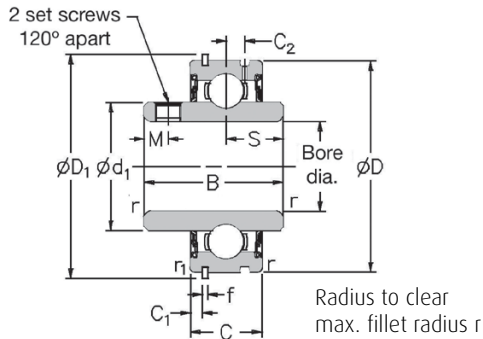

Shaft diameter	RHP designation	Dimensions (mm)											ISO Load ratings			Rec. max. speed rev/min	Mass (approx.) kg
		D	D1	C	C1	C2	B	s	d1	f	M	r	r1	dynamic Cr newtons	static Cor newtons		
20	1120-20CG	47.000	52.68	15.88	2.39	4.17	31.00	12.73	28.30	1.12	5.00	1.00	0.50	12800	6650	6700	0.23
¾	1120-¾CG																
25	1125-25CG	52.000	57.81	19.05	2.39	4.39	34.10	14.33	34.00	1.12	5.00	1.00	0.50	14000	7880	6250	0.31
7/8	1125-7/8CG																
15/16	1125-15/16CG																
1	1125-1CG																
30	1130-30CG	62.000	67.69	22.22	3.18	5.10	38.10	15.93	40.30	1.70	5.00	1.00	0.50	19500	11300	5300	0.42
1 1/8	1130-1 1/8CG																
1 3/16	1130-1 3/16CG																
35	1135-35CG	72.000	78.51	23.81	3.18	5.61	42.90	17.53	46.90	1.70	6.50	1.00	1.00	25700	15300	4500	0.61
1 1/4	1135-1 1/4CG																
1 3/8	1135-1 3/8CG																
1 7/8	1135-1 7/8CG																
40	1140-40CG	80.000	86.51	27.78	3.18	6.22	49.20	19.03	52.40	1.70	8.00	1.00	1.00	32500	19900	4000	0.91
1 1/2	1140-1 1/2CG																
45	1145-45CG	85.000	91.51	27.78	3.18	6.52	49.20	19.04	57.40	1.70	8.00	1.00	1.00	32500	20500	3700	1.05
1 5/8	1145-1 5/8CG																
1 11/16	1145-1 11/16CG																
1 3/4	1145-1 3/4CG																
1 7/8	1150-1 7/8CG	90.000	96.49	28.58	3.18	6.72	51.59	19.10	62.40	2.46	10.00	1.00	1.00	35000	23200	3400	1.10
1 15/16	1150-1 15/16CG																
55	1155-55CG	100.000	106.50	30.16	3.18	7.43	55.60	22.20	68.90	2.46	10.00	1.00	1.00	43500	29200	3100	1.50
2	1155-2CG																
2 3/16	1155-2 3/16CG																

Please check availability

Self-Lube[®] bearing inserts with adapter sleeves

1000-KG and 1100-K Series

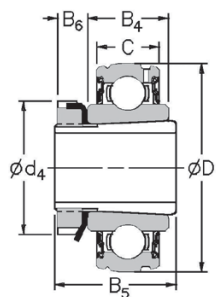

1000-KG

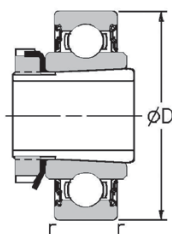

1100-K

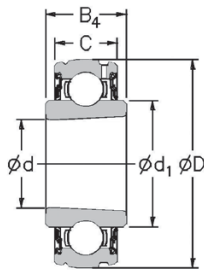

1000KG

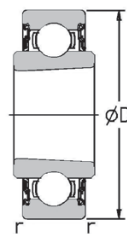

1100K

Bore taper 1:12
on diameter

Shaft diameter		RHP designation		Sleeve nut & lockwasher assembly only	Basic insert without sleeve, nut & lockwasher		Dimensions (mm)		
mm	inches	1000-KG Series	1100-K Series		1000KG	1100K	D	C	B4
20		1025-20KG	1125-20K	H305	1025KG	1125K	52.000	15.00	19.00
	3/4	1025-3/4KG	1125-3/4K	HE305-3/4					
25		1030-25KG	1130-25K	H306	1030KG	1130K	62.000	16.00	20.00
	15/16	1030-15/16KG	1130-15/16K	HE306-15/16					
	1	1030-1KG	1130-1K	HE306-1					
30		1035-30KG	1135-30K	H307	1035KG	1135K	72.000	17.00	21.00
	1 1/8	1035-1 1/8KG	1135-1 1/8K	HE307-1 1/8					
	1 3/16	1035-1 3/16KG	1135-1 3/16K	HE307-1 3/16					
35		1040-35KG	1140-35K	H308	1040KG	1140K	80.000	18.00	22.00
	1 1/4	1040-1 1/4KG	1140-1 1/4K	HE308-1 1/4					
	1 3/8	1040-1 3/8KG	1140-1 3/8K	HE308-1 3/8					
40		1045-40KG	1145-40K	H309	1045KG	1145K	85.000	19.00	23.00
	1 7/16	1045-1 7/16KG	1145-1 7/16K	HE309-1 7/16					
	1 1/2	1045-1 1/2KG	1145-1 1/2K	HE309-1 1/2					
45		1050-45KG	1150-45K	H310	1050KG	1150K	90.000	20.00	24.00
	1 11/16	1050-1 11/16KG	1150-1 11/16K	HE310-1 11/16					
	1 3/4	1050-1 3/4KG	1150-1 3/4K	HE310-1 3/4					
50		1055-50KG	1155-50K	H311	1055KG	1155K	100.000	21.00	25.00
	1 5/8	1055-1 5/8KG	1155-1 5/8K	HE311-1 5/8					
	2	1055-2KG	1155-2K	HE311-2					

Please check availability

Dimensions (mm)						ISO Load ratings		Rec. max. speed rev/min	Mass (approx.) kg
B5	B6	d	d1	d4	r	dynamic Cr newtons	static Cor newtons		
29.00	8.00	25.000	34.00	38.00	1.00	14000	7880	6250	0.20
31.00	8.00	30.000	40.30	45.00	1.00	19500	11300	5300	0.30
35.00	9.00	35.000	46.90	52.00	1.00	25700	15300	4500	0.42
36.00	10.00	40.000	52.40	58.00	1.00	32500	19900	4000	0.54
39.00	11.00	45.000	57.40	65.00	1.00	32500	20500	3700	0.64
42.00	12.00	50.000	62.40	70.00	1.00	35000	23200	3400	0.75
45.00	12.00	55.000	68.90	75.00	1.50	43500	29200	3100	0.95

Self-Lube[®] triple seal bearing inserts

T1000G Series

T1000G

With spherical outside diameter and integral set screw lock

2 set screws
120° apart

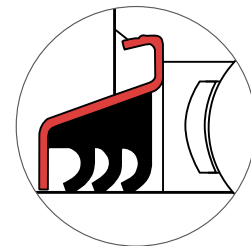
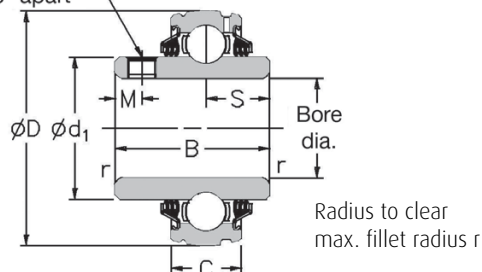

Shaft diameter mm inches	RHP designation	Dimensions (mm)							ISO Load ratings		Rec. max. speed rev/min	Mass (approx.) kg
		D	C	B	s	d1	M	r	dynamic Cr newtons	static Cor newtons		
25	T1025-25G	52.000	15.00	34.10	14.33	34.00	5.00	1.00	14000	7880	1000	0.17
	T1025-7/8G											
	T1025-15/16G											
	T1025-1G											
25	T1030-25G	62.000	18.00	38.10	15.93	40.30	5.00	1.00	19500	11300	850	0.37
30	T1030-30G											
	T1030-7/8G											
	T1030-1G											
	T1030-1 1/8G											
	T1030-1 3/16G											
	T1030-1 1/4G											
30	T1035-30G	72.000	19.00	42.90	17.53	46.90	6.50	1.00	25700	15300	750	0.51
35	T1035-35G											
	T1035-1 3/16G											
	T1035-1 1/4G											
	T1035-1 3/8G											
	T1035-1 7/16G											
35	T1040-35G	80.000	21.00	49.20	19.03	52.40	8.00	1.00	32500	19900	650	0.64
40	T1040-40G											
	T1040-1 3/8G											
	T1040-1 7/16G											
	T1040-1 1/2G											
40	T1045-40G	85.000	22.00	49.20	19.04	57.40	8.00	1.00	32500	20500	600	0.73
45	T1045-45G											
	T1045-1 1/2G											
	T1045-1 5/8G											
	T1045-1 11/16G											
	T1045-1 3/4G											
45	T1050-45G	90.000	23.00	51.60	19.04	62.40	10.00	1.00	35000	23200	550	0.91
50	T1050-50G											
	T1050-1 11/16G											
	T1050-1 3/4G											
	T1050-1 7/8G											
	T1050-1 15/16G											
	T1050-2G											
50	T1055-50G	100.000	25.00	55.60	22.24	68.90	10.00	1.50	43500	29200	500	1.12
55	T1055-55G											
	T1055-1 7/8G											
	T1055-1 15/16G											
	T1055-2G											
	T1055-2 1/8G											
	T1055-2 3/16G											

Please check availability

Shaft diameter		RHP designation	Dimensions (mm)							ISO Load ratings		Rec. max. speed rev/min	Mass (approx.) kg
mm	inches		D	C	B	s	d1	M	r	dynamic Cr newtons	static Cor newtons		
55		T1060-55G	110.000	25.00	65.10	25.44	76.00	10.00	1.50	48000	33000	450	1.50
60		T1060-60G											
	2 ³ / ₁₆	T1060-2³/₁₆G											
	2 ¹ / ₄	T1060-2¹/₄G											
	2 ³ / ₈	T1060-2³/₈G											
	2 ⁷ / ₁₆	T1060-2⁷/₁₆G											
60		T1070-60G	125.000	28.00	74.60	30.24	89.00	12.00	1.50	61000	45000	400	2.30
65		T1070-65G											
70		T1070-70G											
	2 ⁷ / ₁₆	T1070-2⁷/₁₆G											
	2 ¹ / ₂	T1070-2¹/₂G											
	2 ⁵ / ₈	T1070-2⁵/₈G											
	2 ¹¹ / ₁₆	T1070-2¹¹/₁₆G											
75		T1080-75G	140.000	30.00	82.60	33.34	100.00	12.00	2.00	71500	54500	345	3.27
80		T1080-80G											
	2 ¹⁵ / ₁₆	T1080-2¹⁵/₁₆G											
	3	T1080-3G											

Please check availability

Self-Lube[®] triple seal bearing inserts

T1000DECG Series

T1000DECG

With spherical outside diameter and eccentric collar lock

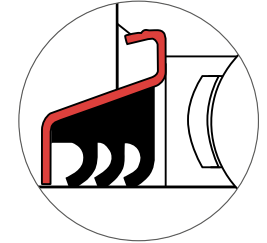
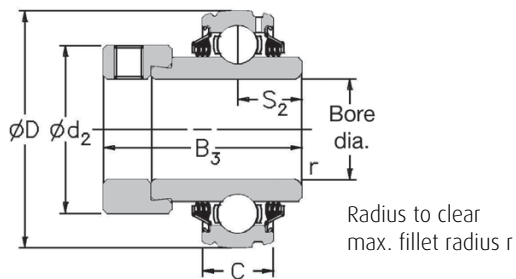

Shaft diameter		RHP designation	Dimensions (mm)					ISO Load ratings			Rec. max. speed rev/min	Mass (approx.) kg
mm	inches		D	C	B3	s2	d2	r	dynamic Cr newtons	static Cor newtons		
25		T1025-25DECG	52.000	15.00	44.43	17.53	38.10	1.00	14000	7880	1000	0.26
	7/8	T1025-7/8DECG										
	15/16	T1025-15/16DECG										
	1	T1025-1DECG										
30		T1030-30DECG	62.000	18.00	48.43	18.33	44.50	1.00	19500	11300	850	0.53
	1 1/8	T1030-1 1/8DECG										
	1 3/16	T1030-1 3/16DECG										
	1 1/4	T1030-1 1/4DECG										
35		T1035-35DECG	72.000	19.00	51.13	18.83	55.60	1.00	25700	15300	750	0.70
	1 1/4	T1035-1 1/4DECG										
	1 3/8	T1035-1 3/8DECG										
	1 7/16	T1035-1 7/16DECG										
40		T1040-40DECG	80.000	21.00	56.33	21.43	60.30	1.00	32500	19900	650	0.82
	1 1/2	T1040-1 1/2DECG										
45		T1045-45DECG	85.000	22.00	56.33	21.43	63.50	1.00	32500	20500	600	1.08
	1 5/8	T1045-1 5/8DECG										
	1 11/16	T1045-1 11/16DECG										
	1 3/4	T1045-1 3/4DECG										
50		T1050-50DECG	90.000	23.00	62.73	24.64	69.90	1.00	35000	23200	550	1.19
	1 7/8	T1050-1 7/8DECG										
	1 15/16	T1050-1 15/16DECG										
55		T1055-55DECG	100.000	25.00	71.42	27.84	76.20	1.50	43500	29200	500	1.40
	2	T1055-2DECG										
	2 1/8	T1055-2 1/8DECG										
	2 3/16	T1055-2 3/16DECG										
60		T1060-60DECG	110.000	25.00	77.84	31.04	84.20	1.50	48000	33000	450	1.81
	2 1/4	T1060-2 1/4DECG										
	2 7/16	T1060-2 7/16DECG										
65		T1070-65DECG	125.000	28.00	85.74	34.14	97.00	1.50	61000	45000	400	2.49
70		T1070-70DECG										

Please check availability

Self-Lube[®] bearing inserts with flinger seals

1000GFS Series

1000GFS

With spherical outside diameter and integral set screw lock

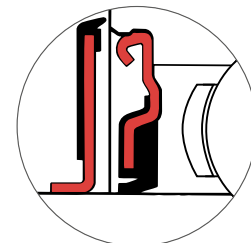
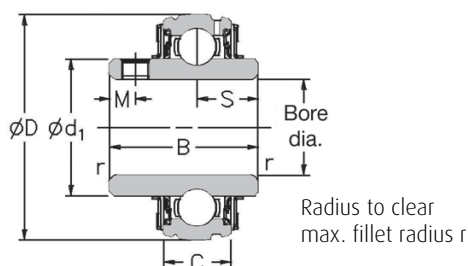

Shaft diameter		RHP designation	Dimensions (mm)							ISO Load ratings		Rec. max. speed rev/min	Mass (approx.) kg
mm	inches		D	C	B	s	d1	M	r	dynamic Cr newtons	static Cor newtons		
25		1025-25GFS	52.000	15.00	34.10	14.33	34.00	5.00	1.00	14000	7880	6250	0.17
	7/8	1025-7/8GFS											
	15/16	1025-15/16GFS											
	1	1025-1GFS											
25		1030-25GFS	62.000	16.00	38.10	15.93	40.30	5.00	1.00	19500	11300	5300	0.37
30		1030-30GFS											
	7/8	1030-7/8GFS											
	1	1030-1GFS											
	1 1/8	1030-1 1/8GFS											
	1 3/16	1030-1 3/16GFS											
	1 1/4	1030-1 1/4GFS											
30		1035-30GFS	72.000	17.00	42.90	17.53	46.90	6.50	1.00	25700	15300	4500	0.51
35		1035-35GFS											
	1 3/16	1035-1 3/16GFS											
	1 1/4	1035-1 1/4GFS											
	1 5/16	1035-1 5/16GFS											
	1 3/8	1035-1 3/8GFS											
	1 7/16	1035-1 7/16GFS											
35		1040-35GFS	80.000	18.00	49.20	19.03	52.40	8.00	1.00	32500	19900	4000	0.64
40		1040-40GFS											
	1 3/8	1040-1 3/8GFS											
	1 7/16	1040-1 7/16GFS											
	1 1/2	1040-1 1/2GFS											
40		1045-40GFS	85.000	19.00	49.20	19.04	57.40	8.00	1.00	32500	20500	3700	0.73
45		1045-45GFS											
	1 1/2	1045-1 1/2GFS											
	1 5/8	1045-1 5/8GFS											
	1 11/16	1045-1 11/16GFS											
	1 3/4	1045-1 3/4GFS											
45		1050-45GFS	90.000	20.00	51.60	19.04	62.40	10.00	1.00	35000	23200	3400	0.91
50		1050-50GFS											
	1 11/16	1050-1 11/16GFS											
	1 3/4	1050-1 3/4GFS											
	1 7/8	1050-1 7/8GFS											
	1 15/16	1050-1 15/16GFS											
	2	1050-2GFS											
50		1055-50GFS	100.000	21.00	55.60	22.24	68.90	10.00	1.50	43500	29200	3100	1.12
55		1055-55GFS											
	1 7/8	1055-1 7/8GFS											
	1 15/16	1055-1 15/16GFS											
	2	1055-2GFS											
	2 1/8	1055-2 1/8GFS											
	2 3/16	1055-2 3/16GFS											
55		1060-55GFS	110.000	22.00	65.10	25.44	76.00	10.00	1.50	48000	33000	2800	1.47
60		1060-60GFS											
	2 3/16	1060-2 3/16GFS											
	2 1/4	1060-2 1/4GFS											
	2 3/8	1060-2 3/8GFS											
	2 7/16	1060-2 7/16GFS											

Please check availability

Self-Lube[®] bearing inserts with flinger seals

1000DECGFS Series

1000DECGFS

With spherical outside diameter and eccentric collar lock

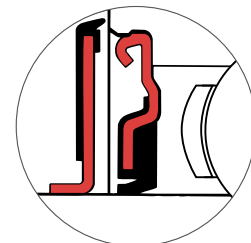
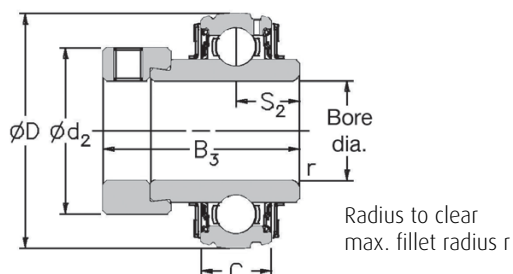

Shaft diameter		RHP designation	Dimensions (mm)					ISO Load ratings		Rec. max. speed rev/min	Mass (approx.) kg	
mm	inches		D	C	B3	s2	d2	r	dynamic Cr newtons			static Cor newtons
25		1025-25DECGFS	52.000	15.00	44.43	17.53	38.10	1.00	14000	7880	6250	0.26
	7/8	1025-7/8DECGFS										
	15/16	1025-15/16DECGFS										
	1	1025-1DECGFS										
30		1030-30DECGFS	62.000	16.00	48.43	18.33	44.50	1.00	19500	11300	5300	0.53
	1	1030-1 1/8DECGFS										
	1 1/16	1030-1 1/16DECGFS										
	1 1/4	1030-1 1/4DECGFS										
35		1035-35DECGFS	72.000	17.00	51.13	18.83	55.60	1.00	25700	15300	4500	0.70
	1 1/4	1035-1 1/4DECGFS										
	1 5/16	1035-1 5/16DECGFS										
	1 3/8	1035-1 3/8DECGFS										
	1 7/16	1035-1 7/16DECGFS										
40		1040-40DECGFS	80.000	18.00	56.33	21.43	60.30	1.00	32500	19900	4000	0.82
	1 1/2	1040-1 1/2DECGFS										
45		1045-45DECGFS	85.000	19.00	56.33	21.43	63.50	1.00	32500	20500	3700	1.08
	1 5/8	1045-1 5/8DECGFS										
	1 11/16	1045-1 11/16DECGFS										
	1 3/4	1045-1 3/4DECGFS										
50		1050-50DECGFS	90.000	20.00	62.73	24.64	69.90	1.00	35000	23200	3400	1.19
	1 7/8	1050-1 7/8DECGFS										
	1 15/16	1050-1 15/16DECGFS										
55		1055-55DECGFS	100.000	21.00	71.42	27.84	76.20	1.50	43500	29200	3100	1.40
	2	1055-2DECGFS										
	2 1/8	1055-2 1/8DECGFS										
	2 3/16	1055-2 3/16DECGFS										
60		1060-60DECGFS	110.000	22.00	77.84	31.04	84.20	1.50	48000	33000	2800	1.72
	2 1/4	1060-2 1/4DECGFS										
	2 3/8	1060-2 3/8DECGFS										
	2 7/16	1060-2 7/16DECGFS										

Please check availability