



D027VF001-00
UK
Version 0

Quick Setup Guide



DCP-L3515CDW / DCP-L3520CDW / DCP-L3520CDWE / DCP-L3527CDW /
DCP-L3555CDW / DCP-L3560CDW / MFC-L3740CDW / MFC-L3740CDWE /
MFC-L3760CDW / MFC-L8340CDW / MFC-L8390CDW

Read the *Product Safety Guide* first, then read this *Quick Setup Guide* for the correct installation procedure.
Not all models are available in all countries.

EN



Video setup instructions:
support.brother.com/videos



The latest manuals are available at the Brother support website:
support.brother.com/manuals

Unpack the machine and check the components

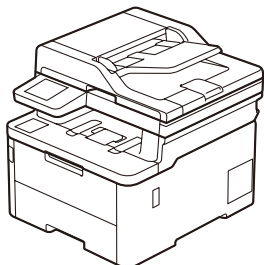

Toner Cartridge and Drum Unit Assemblies*
(Black, Cyan, Magenta, and Yellow)

* Installed in the machine

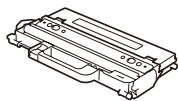

Waste Toner Box*



AC Power Cord

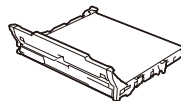

Belt Unit*

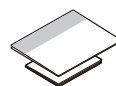

**Quick Setup Guide
Product Safety Guide**

NOTE:

- The components included in the box may differ depending on your country.
- The available connection interfaces vary depending on the model. You must purchase the correct interface cable if you require one.

- **USB cable**
We recommend using a USB 2.0 cable (Type A/B) that is no more than 2 metres long.
- **Network cable (DCP-L3555CDW / DCP-L3560CDW / MFC-L3740CDW / MFC-L3740CDWE / MFC-L3760CDW / MFC-L8390CDW)**
Use a straight-through Category 5 (or greater) twisted-pair cable.

- The illustrations in this *Quick Setup Guide* show the MFC-L8390CDW.
- Brother aims to reduce waste and save both raw materials and the energy required to produce them.
Read more about our environmental work at www.brotherearth.com.

1 Remove the packing materials and re-install the toner cartridge and drum unit assemblies

Remove all the blue packing tape.

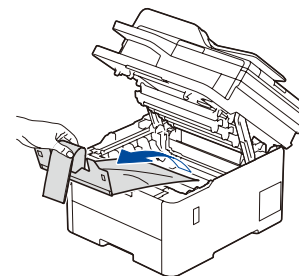
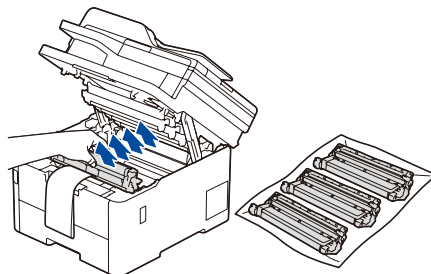
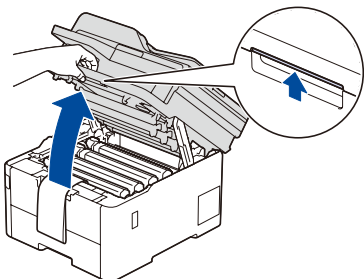

Remove the orange parts from each cartridge.

x4

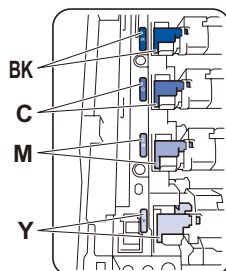
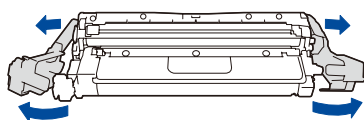

Push firmly.

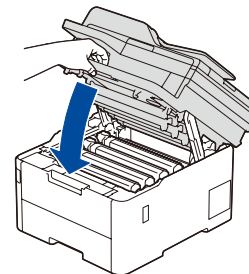
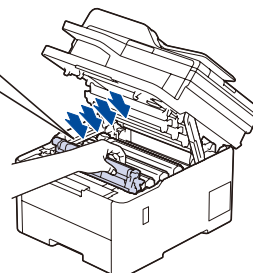

2 Load paper in the paper tray

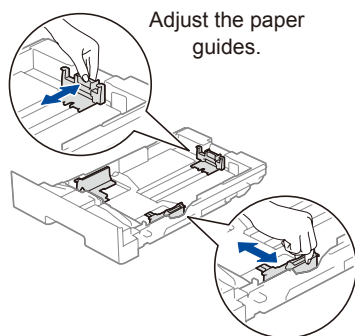
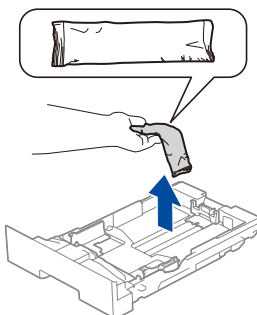
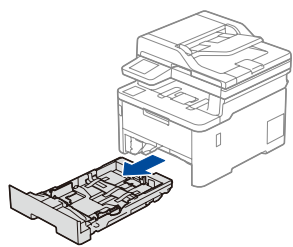

Do not exceed this mark.

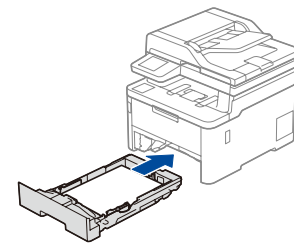
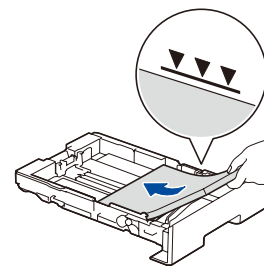

3 Connect the power cord and turn the machine on

NOTE:

Before connecting the power cord, locate the Serial Number label on the back or side of the machine. Record this number for Registration and Warranty support.

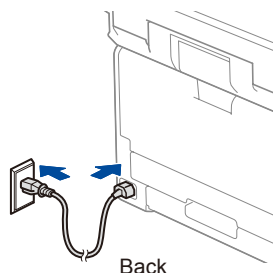

Back

Location of the power button varies depending on the model.

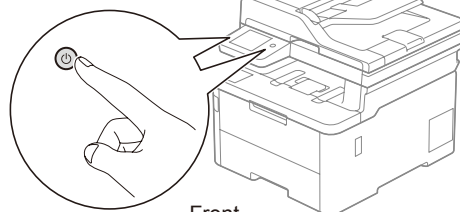

Front

4 Select your country/language (Initial setup only)

After turning the machine on, you may be required to set your country or language (depending on your machine).
If required, follow the on-screen instructions.



5 Select your language (if needed)

■ For LCD models

1. Press **Menu**.
2. Press ▲ or ▼ to display [Initial Setup], and then press **OK**.
3. Press ▲ or ▼ to display [Local Language], and then press **OK**.
4. Press ▲ or ▼ to select your language, and then press **OK**.
5. Press **Stop/Exit**.

■ For Touchscreen models

1. On the machine's Touchscreen, press [Settings] > [All Settings] > [Initial Setup] > [Local Language].
2. Press your language.
3. Press

6 Connect the telephone line cord (For MFC models)

If you do not plan to use the fax feature on this machine, go to step 7.

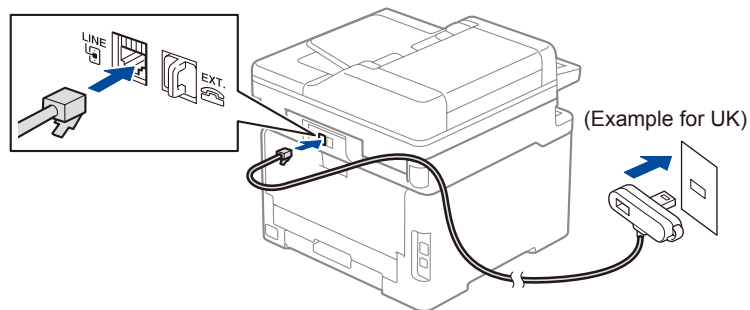

(For Europe)
We can send you a genuine Brother cord free of charge if you need one. To contact us, visit www.brother.eu.

7 Connect your computer or mobile device to your machine

Follow these steps to complete the setup using one of the connection types available on your machine.

Visit setup.brother.com to download and install Brother software.

▶ Follow the on-screen instructions and prompts. ▶ **Setup Finished**

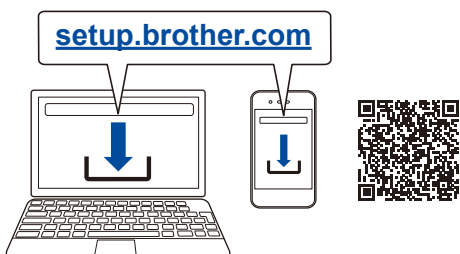

You can now print and scan using your machine. To check for the latest firmware, visit support.brother.com/up7.

Important Notice for Network Security:
The default password to manage this machine's settings is located on the back of the machine and marked "Pwd". We recommend immediately changing the default password to protect your machine from unauthorised access.

Can't Connect? Check the following:

Wireless network	▶ Restart your wireless access point/router (if possible).	▶ Restart your machine and computer, and then go to 7.	▶ If still not successful, go to 8.
Wired network USB connection	▶ Disconnect the cable.		▶ If still not successful, visit support.brother.com for FAQs and Troubleshooting.

8 Manual wireless setup (Wireless models)

If the wireless setup is not successful, try to set up the connection manually.

Find your SSID (Network Name) and Network Key (Password) on your wireless access point/router and write them in the table provided below.

SSID (Network Name)	
Network Key (Password)	

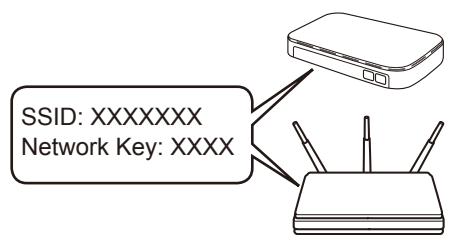

If you cannot find this information, ask your network administrator or wireless access point/router manufacturer.

■ For LCD models

- Press **Menu**, and then select [Network] > [WLAN (Wi-Fi)] > [Find Network]. Follow the LCD instructions.

■ For Touchscreen models

- Press > [Find Wi-Fi Network]. Follow the Touchscreen instructions.

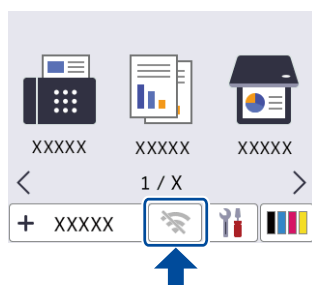

Select the SSID (Network Name) for your access point/router and enter the Network Key (Password).

• For LCD models

- Press and hold ▲/▼ to select one of the following characters:
0123456789abcdefghijklmnopqrstuvwxyz Z(space)!"#\$%&'()*+,-./:;<=>@[\] ^ _ { } ~

▶ Go to 7 to install software.

When the wireless setup is successful, the Touchscreen/LCD displays [Connected].

If setup is not successful, restart your Brother machine and your wireless access point/router, and repeat 8.