

## PACKAGE CONTENT

1. XPG STARKER AIR C Chassis
2. XPG STARKER AIR C Quick Installation Guide
3. Warranty Guide
4. VGA Bracket x1 for Vertical Installation
5. Accessory Box

## ACCESSORY BOX CONTENTS

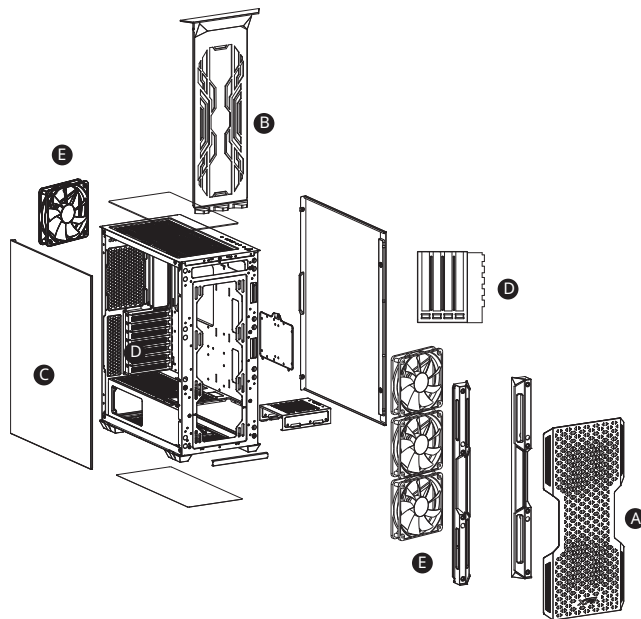
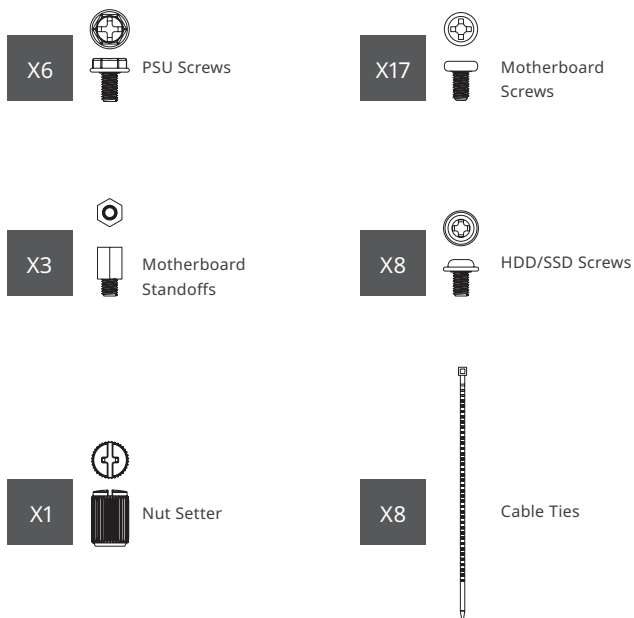

## XPG STARKER AIR C COMPACT MID-TOWER CHASSIS

- A** ..... Magnetic Front Panel
- B** ..... "Removable-on-Rail" Dust Filter
- C** ..... Glass Panel
- D** ..... Replaceable VGA Brackets
- E** ..... 4x XPG VENTO 120 ARGB Fan Included

## SPECIFICATIONS

Color	Black / White	
Form Factor	Mini-ITX, Micro-ATX, ATX	
Dimensions (H x W x D)	465 x 215 x 400mm 18.3 x 8.5 x 15.7inch	
PCI-E Slots	7 Horizontal / 4 Vertical (Transformable for Vertical GPU Support)	
3.5" Drive Bay	2+1 (Combo 3.5" / 2.5")	
2.5" Drive Bay	2+1 (Combo 3.5" / 2.5")	
Fan Mounts	FRONT	140mm x2 / 120mm x3
	TOP	140mm x2 / 120mm x2
	REAR	120mm x1
Fan Pre-Installed	FRONT	XPG VENTO 120 ARGB x3
	REAR	XPG VENTO 120 ARGB x1
Radiator Support	FRONT	360 / 280 / 240mm x1
	TOP	280 / 240 / 120mm x1
	REAR	120mm x1
I/O Ports	2x USB 3.0 Type-A, 1x USB 3.2 Type-C 1x Hybrid Audio Port, 1x LED Button 1x Reset Button, 1x Power Button	
Compatibility	VGA Length	Up to 350mm
	CPU Cooler Height	Up to 165mm
	PSU Length	Up to 160mm
Warranty	2 Years	

## DIMENSIONS AND COMPATIBILITY

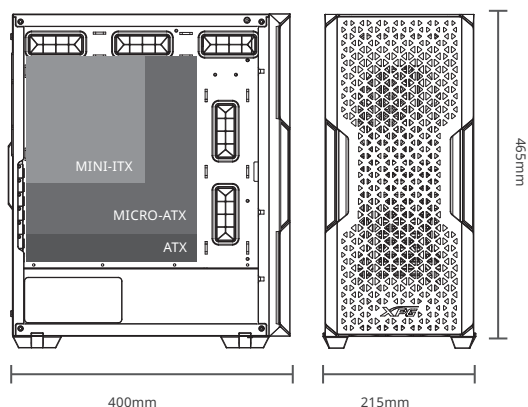

## FRONT I/O BUTTONS AND PORTS

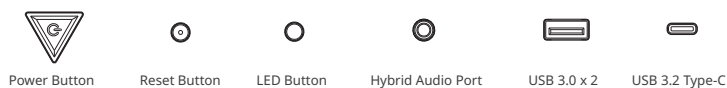

## FRONT I/O CABLES

Please consult your user manual of motherboard manufacturer, then connect these leads to the panel header on the motherboard.

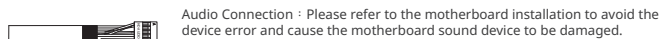

## PRE-SET LIGHTING EFFECTS

MODE DESCRIPTIONS				
MODE 1	MODE 2	MODE 3	MODE 4	MODE 5
RED	GREEN	BLUE	PURPLE	YELLOW
MODE 6	MODE 7	MODE 8	MODE 9-12	MODE 13
WHITE	ORANGE	NEON GREEN	LIGHTING EFFECT NO. 1-4	OFF

## INSTALLING PCI-E CARD

Horizontal Installation

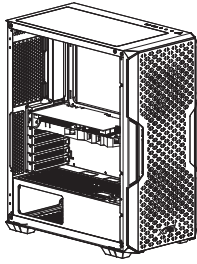

Vertical Installation

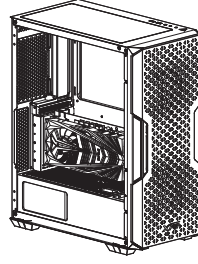

## INSTALLING PCI-E CARD : VERTICAL

Remove the pre-installed Horizontal VGA bracket, and replace it with the included Vertical bracket.

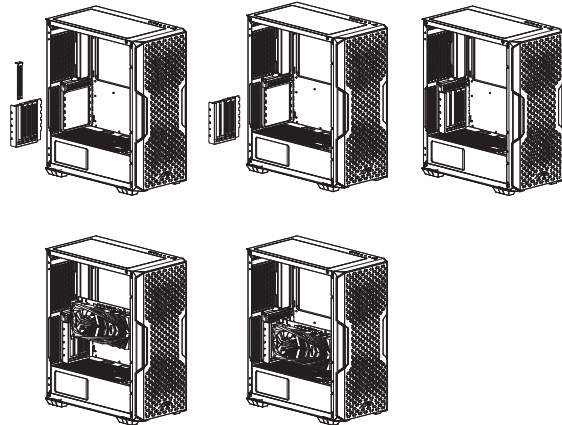

## POWER SUPPLY INSTALLATION

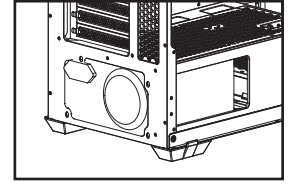
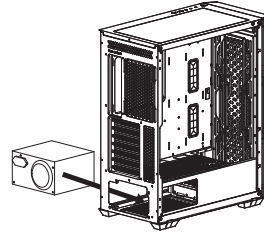

## INSTALLING COMBO STORAGE

Included Drive plate can install x1 3.5" HDD on top of PSU compartment, or x2 2.5" HDD/SSD at the back of the chassis.

STORAGE	
3.5" HDD	2*(COMBO 3.5"/2.5")
2.5" HDD/SSD	2*(COMBO 3.5"/2.5")

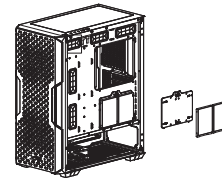
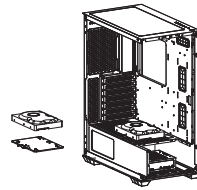

\* Support up to x2 2.5" HDD/SSD  
\* Secure the drives to the plate with screws

## DRIVES INSTALLATION

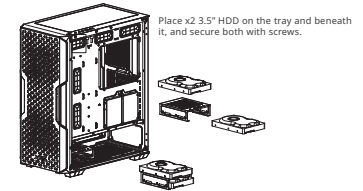

Place x2 3.5" HDD on the tray and beneath it, and secure both with screws.

OR

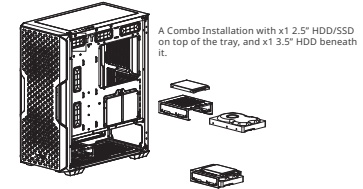

A Combo Installation with x1 2.5" HDD/SSD on top of the tray, and x1 3.5" HDD beneath it.

## CLEANING INSTRUCTIONS

Please use a clean damp cloth to clean the product properly. Do not apply any soap or solvent agent on the surface to preserve its integrity.

## SAFETY INSTRUCTIONS

For a proper use of the product, and to ensure your safety, please follow the following instructions:

1. Keep the device away from liquids, excess humidity or moisture to avoid any shock hazards. Should the device come into contact with liquids, please make sure to unplug the device immediately, store it in a dry place, and contact support for assistance.
2. Operate the device only within the specific temperature range of 0°C (32°F) to 40°C (104°F). Should the temperature exceed this range, unplug and/or switch off the device in order to let the temperature stabilize to an optimal level.
3. Should you have any other trouble operating the device properly and normal troubleshooting does not work, please unplug the device and contact our service for support.
4. Do not attempt to service or fix the device by yourself at any time.

## DURATION OF WARRANTY

ADATA Technology Co., Ltd. provides a two-year warranty period for this product unless regional laws and regulations state otherwise.

## LIMITATION OF WARRANTY

This limited warranty covers only repairs or replacements of products manufactured by ADATA Technology Co. Ltd. and its authorized partners.

Please note that ADATA is responsible for providing free repairs except for the following reasons:

1. The warranty label is altered, damaged or missing.
2. Product serial number does not conform to our original system.
3. Products purchased from an unauthorized agent.
4. Damage caused by natural calamity
5. Any abuse outside the intended product operation.

## ONLINE CUSTOMER SERVICE

For frequently asked questions, additional information and service instruction please visit the product page at [www.xpg.com](http://www.xpg.com)

## 限用物质及其化学符号 (Restricted substance and its chemical symbols)

部件名称	铅 Pb	汞 Hg	镉 Cd	六价铬 Cr (VI)	多溴联苯 PBB	多溴二苯醚 PBDE
电路板	○	○	○	○	○	○
机壳	○	○	○	○	○	○
附件	○	○	○	○	○	○

本表格依据SJ/T 11364的规定编制。

○ : 在该零部件的所有均质材料中的有害物质的含量不超过GB/T 26572标准规定的限量要求。

× : 在该零部件中至少均质材料中的有害物质的含量超过GB/T 26572标准规定的限量要求。( × 判定: 包括 EU RoHS的豁免项目)

[www.XPG.com](http://www.XPG.com)

ADATA Technology Co., Ltd.

Product Name: XPG STARKER AIR C

产品类别: PC 机箱/PC 机箱

委製商: 威刚科技股份有限公司/威刚科技股份有限公司

地址: 235 新北市中和區連城路258號2樓/新北市中和區連城路258號2樓

Tel: +886-2-8228-0886 Fax: +886-2-8228-0887

MADE IN CHINA

產地: 中國/中国