

National Weather Service Partial County Alerting

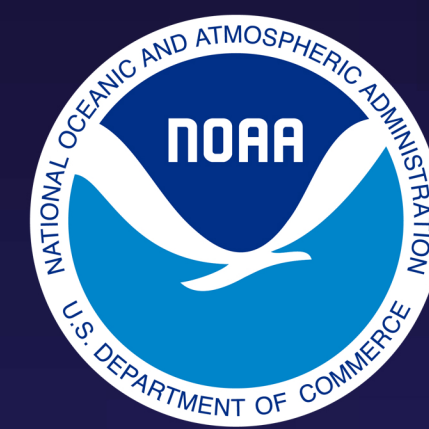

What is Partial County Alerting?

Partial County Alerting (PCA) provides more geographically-precise weather alerts.

It means you will receive fewer watches and warnings with NOAA Weather Radio (NWR) Specific Area Message Encoding (SAME) receivers. PCA also results in fewer programming interruptions on local TV, radio and cable systems relaying National Weather Service (NWS) warnings via the Emergency Alert System (EAS).



Partial County Alerting Explained

Partial County Alerting (PCA) provides more geographically-precise weather alerts on NOAA Weather Radio and the Emergency Alert System.

This means the alerts you receive are relevant to your area.

Legend:



Area at risk



Area alerted

Without PCA

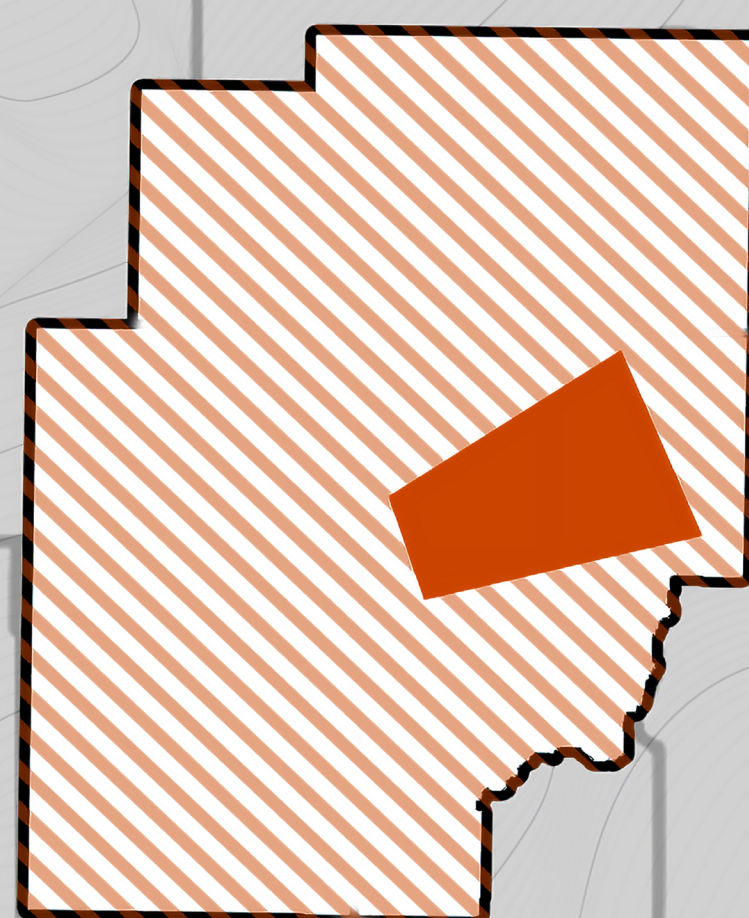

Without PCA, the entire county is alerted, even though only a small section is at risk.

With PCA

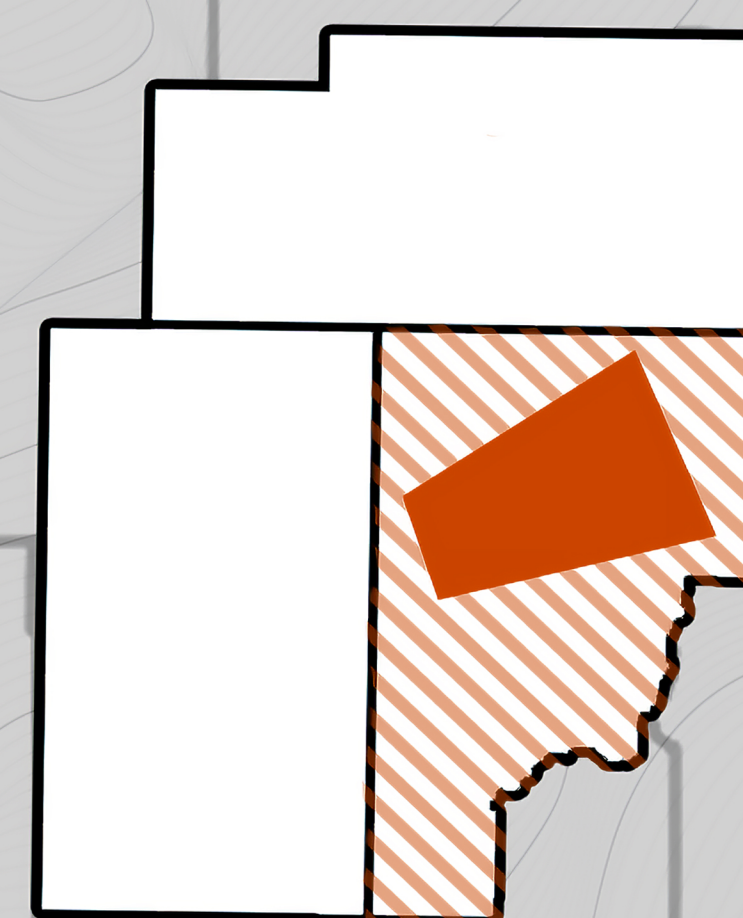

A Partial County Alert limited to only the impacted section of the county.



To prepare a county for implementation of PCA, the NWS, broadcasters and local officials coordinate to split a county into parts, based on weather patterns, county shape, media markets, population centers and other factors.

The full benefits of PCA require the use of an NWR SAME receiver.

If PCA is implemented for a county, NWR listeners can program their radios with a specific, 6-digit location code to receive alerts for the part of a county they live and/or work in.

Similarly, your local TV and radio broadcasters and cable systems can use the enhanced information to make more targeted decisions on when to interrupt local programming.

For more information, visit [weather.gov/pca](https://www.weather.gov/pca).

